

Guardian Angel



GA1000

Digital Vital Sign Monitoring System

Quick User Guide

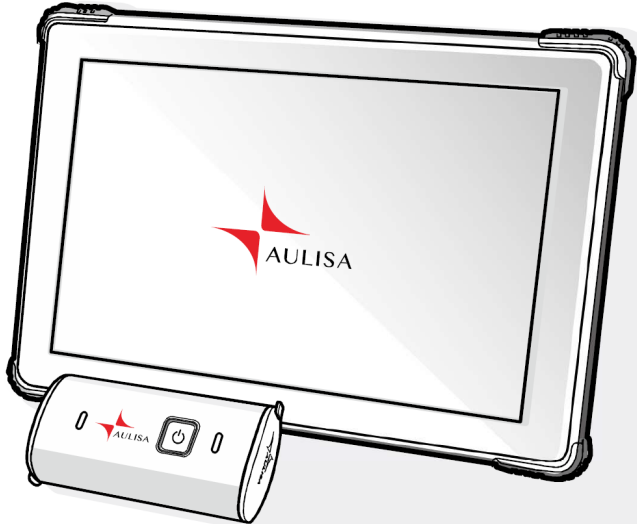

System Overview

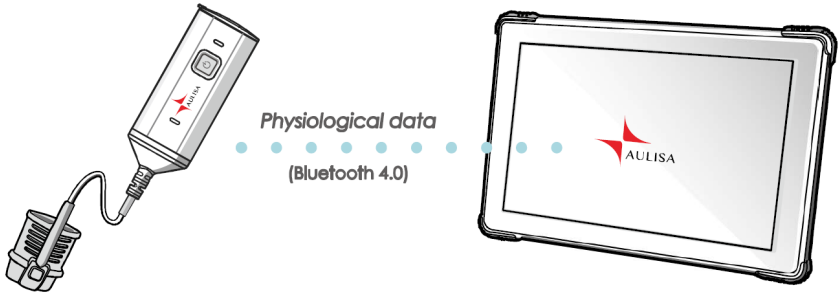

Note: The Sensor Module must be used within 10 meters (32.8 feet) from the Display Unit.

System Contents



Sensor Module
(2 pcs)

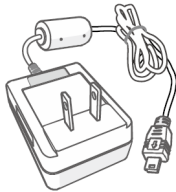

Charging Adaptor-
Sensor Module



Wristband



Adult
Finger Sensor



Display Unit

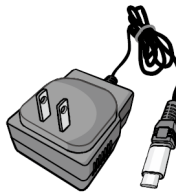

Charging Adaptor-
Display Unit (with
Type-C Converter)

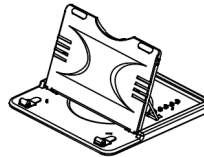

Stand-
Display Unit

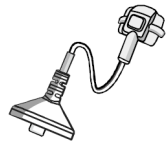

Pediatric
Finger Sensor

Device Overview

Sensor Module (SM)

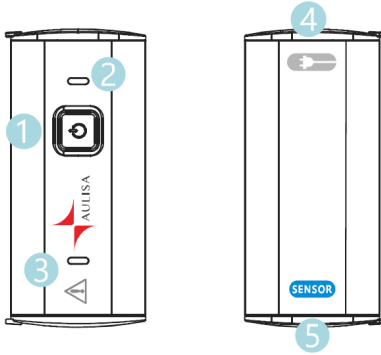

Front View

Back View

- 1 Power button
- 2 Power LED
- 3 Alarm LED
- 4 Charging port
- 5 Sensor port

Display Unit (DU)

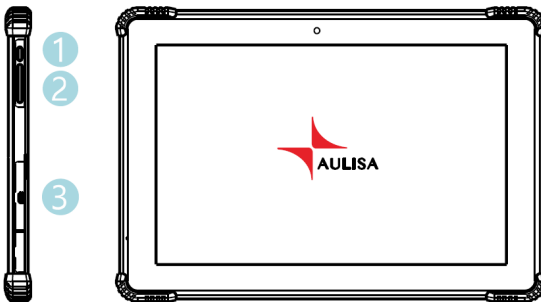

- 1 Power button
- 2 Volume button
- 3 Charging port

System Setup

- 1 Charge the Sensor Module fully prior to use (around 3 hours) with its charging adaptor(white). Plug the mini-USB end of the adaptor into the charging port on the Sensor Module marked by .

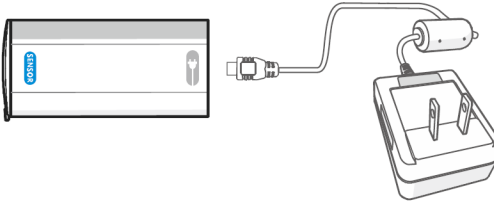

Status	Color
Charging	Blue
Fully Charged	Off

- 2 Power the Display Unit with its charging adaptor(black). Press and hold the power On/Off button for at least three(3) seconds to turn on.

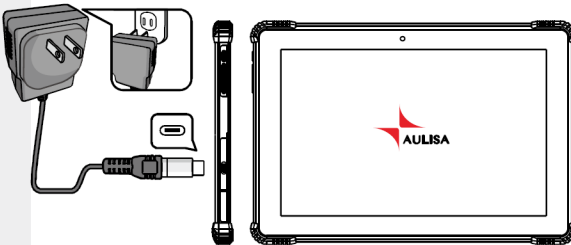

Status	Color
Charging	Red
Fully Charged	Blue

- 3 **Select the correct timezone.**

Note: The MAIN screen will be displayed after selection.

- 4 **Assemble the Sensor Module.**

Attach the connector end of the Finger Sensor to the end marked with **SENSOR** of the Sensor Module.

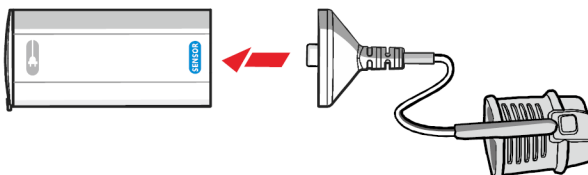

5 Wear the Sensor Module.

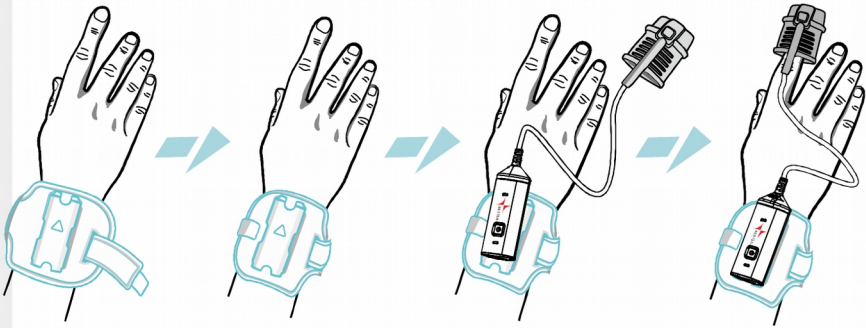

Note: The wristband should be worn with the arrow indicator facing towards the patient's hand.

Note: Attach the sensor probe to the thumb or finger, making sure that Finger Sensor cable runs over the top of the patient's hand.

6 Click the power On/Off button to turn on the Sensor Module.

Status	Color
Power On	Green

7 Pair the devices.

The Display Unit will automatically scan and connect to the Sensor Module. If not, press **PAIR** on the MAIN screen of the Display Unit to force the system to pair.

Note: The Sensor Module must be used within 10 meters (32.8 feet) from the Display Unit.

Note: The Bluetooth connection status icon  will turn blue once the Sensor Module is paired with the Display Unit.

Note: The power LED on the Sensor Module will blink green when pairing with the Display Unit is established, and data is being transmitted.

Display

The screenshot shows the main display with the following elements:

- Top Bar:** AULISA logo, MAIN status, and user information (John Smith, SM A1000).
- Vital Signs:** SpO₂ % (98), PR bpm (70), and PA (2.94).
- Alarm Limits:** 85 (SpO₂ Lower Alarm Limit), 150 (PR Upper Alarm Limit), and 50 (PR Lower Alarm Limit).
- Control Icons:** Sleep Mode (Zzz), Edit Profile (User), and Settings menu (Gear).
- Status Icons:** SM Battery Level, Sensor Cable Connection Status, Bluetooth Connection Status, and Measurement Site Status.

Alarm System

The screenshot shows the alarm system interface with the following elements:

- High Priority Alarms:**
 - 3 beeps/2 beeps every 5 seconds
 - Rapid red flashing light with blinking red alarm text message
- Medium Priority Alarms:**
 - 3 beeps/2 beeps 25 seconds
 - Slow yellow flashing light with blinking yellow text message
- Active Alarms:** SpO₂, LOW (red) and SENSOR MODULE BATTERY LOW (yellow).
- Control Options:** 2-minute Audio Pause or Turn Off Audio.

Alarm Delay Feature

A countdown timer and  will be displayed on the MAIN screen when the alarm limit has been breached and the alarm is being delayed. The alarm will be delayed until the timer counts down to zero.

Default Alarm Settings



High Priority Alarms	High SpO ₂	Low SpO ₂	High Pulse Rate	Low Pulse Rate
Factory Default	Off	85%	150 BPM	50 BPM

Adjust Alarm Limits



Turn On or Off Alarm Limits



Adjust Values



Save



Customer Support

Please visit www.Aulisa.com/CustomerSupport for Customer Support options.

This guide is for reference ONLY. Refer to the Instructions For Use for complete information, warnings, cautions and specifications for Aulisa GA1000 system.



Taiwan Aulisa Medical Devices Technologies, Inc.
No. 218-2, Chong Yang Rd., Nangang Dist.
Taipei, 115 Taiwan
Tel +886-2-2655-7297
www.aulisa.com

Distributed by
Aulisa Medical USA, Inc.
999 Commercial Street, Suite 208
Palo Alto, CA 94303

©2018 Taiwan Aulisa Medical Devices Technologies, Inc.